

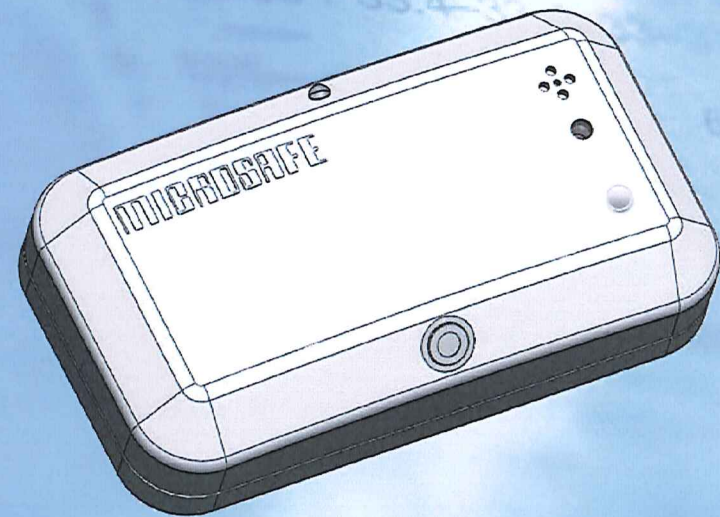

## Quickreference for stove guard



<b>Alarm</b>	<b>Too high temperature</b>
Alarm indication	Three beeps every 5 seconds for 40 seconds (and flashing of red LED).
Measure	Press control button - gives five minutes to "fix" the problem / change status.

<b>Alarm</b>	<b>Timing Alarm (After 2 hours of use)</b>
Alarm indication	One beep every 30 seconds for 5 minutes before disconnection.
Measure	Press control button - provides 30 new minutes of operation.

<b>Alarm</b>	<b>When the stove / cooktop is without power</b>
Alarm indication	Stove / cooktop is "dead".
Measure	Press control button (Note: If this does not work, replace the battery. See below).

<b>Alarm</b>	<b>In the need of battery replacement</b>
Alarm indication	Two beeps every minute.
Measure	Pull the sensor against you (releasing it from the bracket). Remove the two screws in the bottom cover, and replace batteries (Two AAA-batteries). To ensure operation you have 15 minutes to replace batteries.

Applies only to Mkomfy 16R/25R (wireless model)

**NB!** If none of this helps, turn the fuse for the stove off and on. You will then have power for the stove for 24 hours. Contact your electrician, and he will sort out the issue.

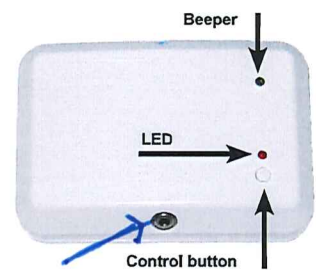

TEMPERATURE SENSOR  
(HAVE TO BE CLAEN  
REGULARY)



A world of possibilities

MANUFACTURER  
CTM Lyng AS  
Tel: +47 72 83 16 11  
<http://www.ctmlyng.no>

MIGROS SAFE®

# Test procedure

To ensure that the function of the Mkomfy stove guard is in order, it is recommended that the following test of the product and the communication is performed:

**1.**

Set slide switch 4 to the ON-position (This is inside the sensor. The factory setting is at the OFF-position).

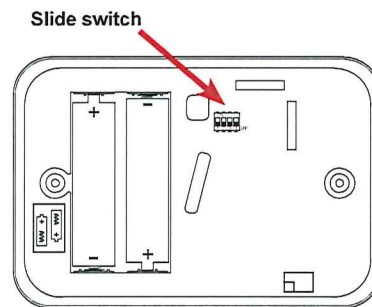

**2.**

Shortly press the control button on the front of the sensor. The sensor now gives a beep about every two seconds.

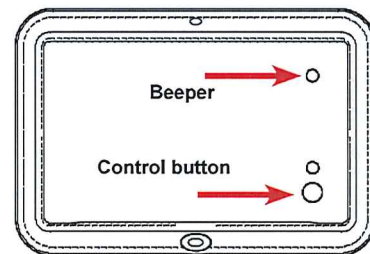

**3.**

Point the sensor against your forehead. The unit will now turn off, since the temperature registered is higher than 30°C.

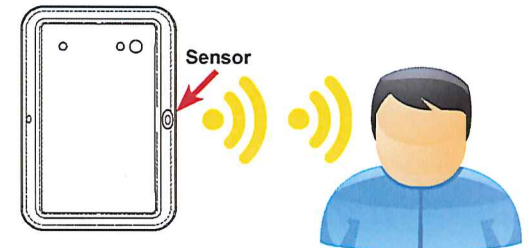

**4.**

Point the sensor against cold cooktop or other cool surface. The unit will now turn on, since the temperature registered is lower again.

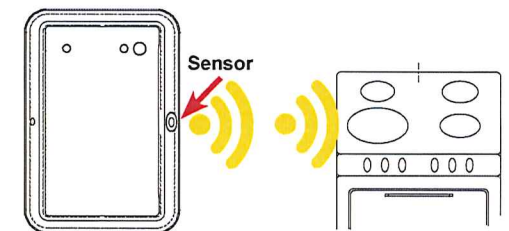

If a step does not work as described, see the page for various alarm situations, or visit [www.ctmlyng.no/komfyrvakt](http://www.ctmlyng.no/komfyrvakt) for more information.

If everything works ... You have now tested that the sensor, communication and outlet are working properly. Further testing is not required.

**NB! Set slide switch 4 back to the OFF-position, before attaching the back cover, and reinstall the sensor (see installation instructions)**